

600AT

SIZE $\phi 15.90\text{mm} \times 110.25\text{mm}$

CAPACITY Cup: 10.6mm

MATERIAL Cap: ABS+AS / BODY: ABS+AS

Lomei

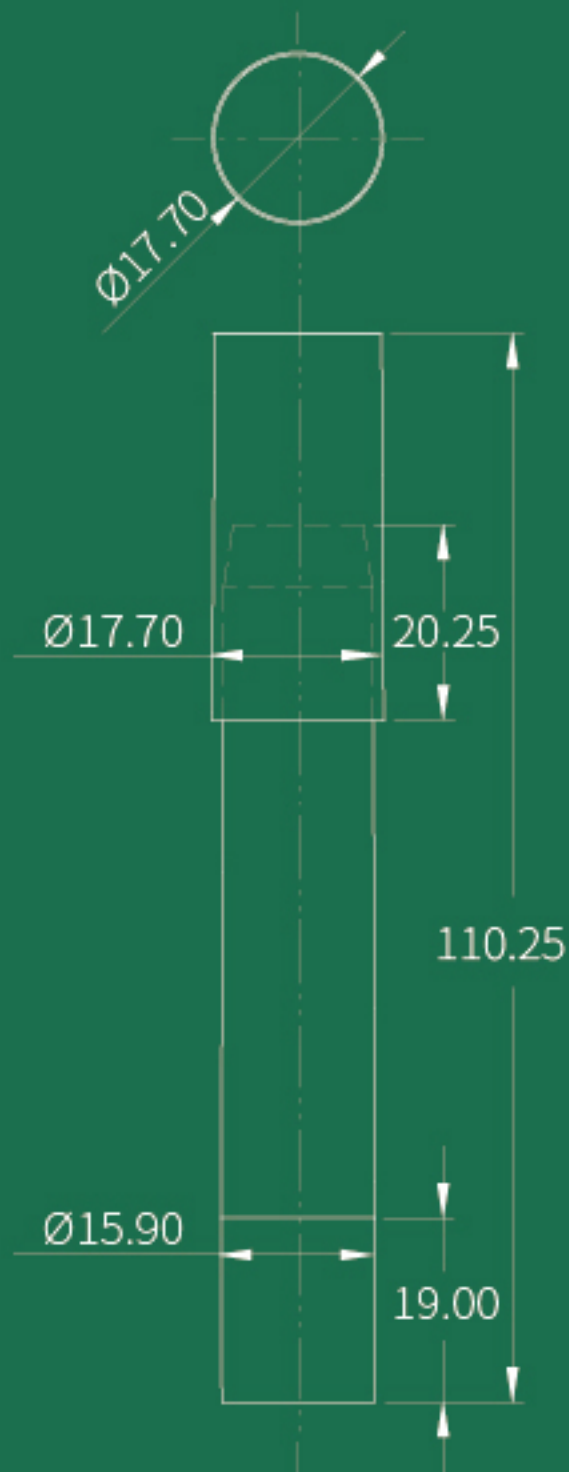

900AT

SIZE Φ 12mm x 129.35mm

CAPACITY Cup:7.4mm

MATERIAL Cap/Base/Bottom: ABS | Sleeve: POM

Lomei

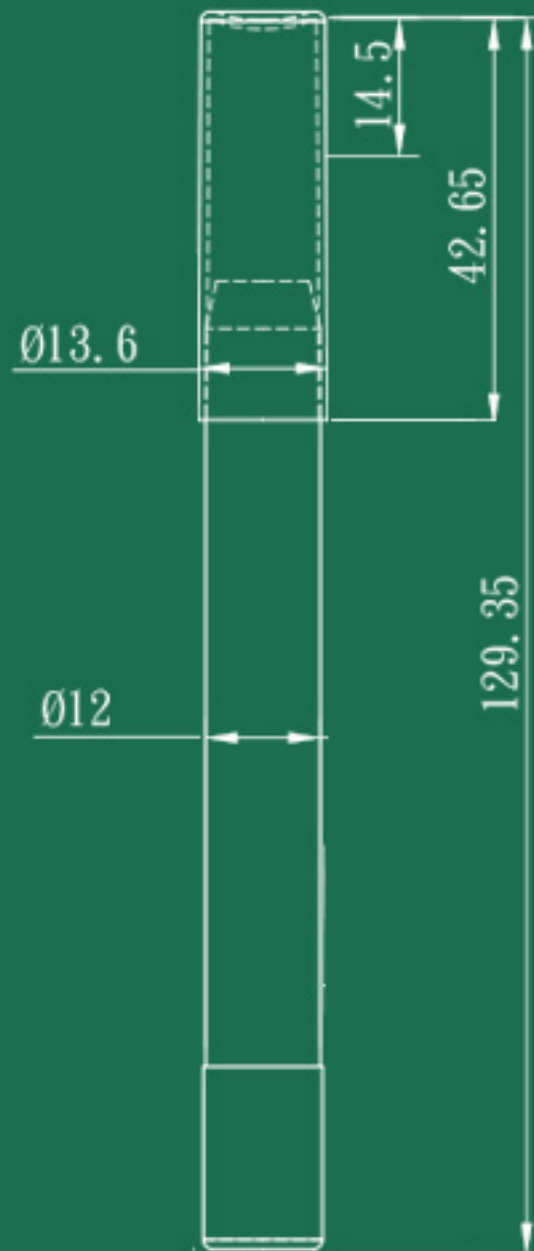

LKS116

SIZE $\phi 14.0 \text{ mm} \times 117.0 \text{ mm}$

MATERIAL Cap: PP / Base: PP / Sleeve: ABS / Cup: POM

Lomei

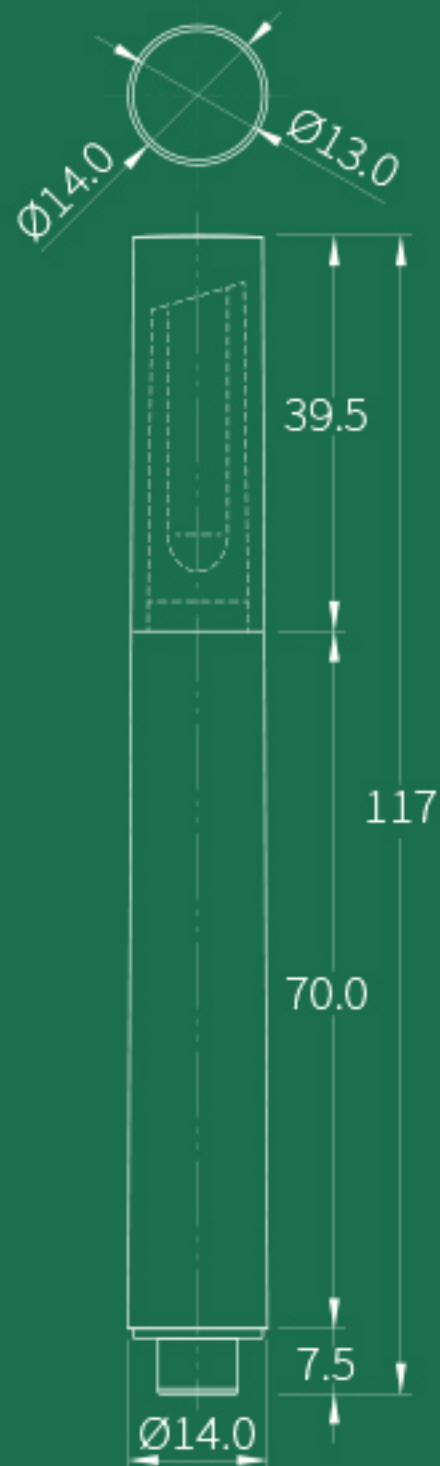

LKS30

SIZE Φ 13.9mm x 99mm

CAPACITY 1.2g

MATERIAL ABS

Lomei

